

Pearland High School  
Oiler Training Camp  
July 27, 2021

**2025**

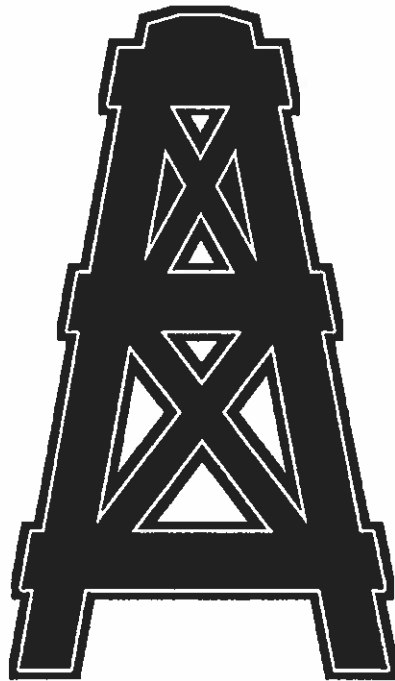

**2022**

**2023**

**2024**

# Oiler Training Camp Guide

Oiler Training Camp Agenda

Welcome Letter

Profile of a Graduate

PHS Oiler Fight Song / School Song

Oiler Quick Reference

Oiler Expenses

PISD Student Dress Code

Attendance Policy

Tardy Policy

Bell Schedules

Building Maps



# PEARLAND HIGH SCHOOL

## *Pride Honor Success*

*"Cultivating a culture of excellence  
that nurtures our students' empathy, education, and passion"*

John Palombo **Principal**

**Associate Principal**  
Audie Johnson

**Assistant Principals**  
Christina Foos  
Andrea Gobert  
Stephanie Jaracz  
Eric Maxwell  
Nicole Sebok  
Lynn Walker  
Tasha Williams

Dear Newest Oiler,

Welcome to the Oiler Family! I know walking into a new place can be exciting and uneasy all at the same time. Know that you are in a great place that loves each and everyone of our Oilers, new and old. As you begin to find your niche, know that the staff and students in this family are here to help you. If you have a specific interest, but do not know where to start...ask. If you do not know where something is...ask. We are here to support you.

We are here to support you not only with becoming acclimated to Pearland High School, but also to support and prepare you for your passion beyond high school. At Pearland High School, we take pride in developing young adults passions while celebrating the deep traditions of the Oiler Family. We take pride in not only celebrating our traditions, but also creating traditions for the Oilers to come.

Make sure to get involved in the many things happening throughout the year. Join the student section at Friday Night Lights in The Rig, Pressure Pit, or the ball fields. Come watch our band, choir, thespians or Prancers perform in our Performing Arts Center. Or better yet, join one of these wonderful groups where your family and friends can come and watch you. If these organizations do not peak you interest join one of our many clubs, JROTC or Academic Decathlon team. We have something for everyone here at Pearland High School.

Over the coming days and years, I encourage you to be involved. Being involved is the best way to build a support system for you. Know that your support system goes beyond just an organization. You will have an assistant principal and counselor who will support you on your journey and challenges that may arise along with the countless teachers, directors, or coaches you will work with as well as me. Know that we are all here to support YOU!

I hope your first few days as an Oiler are great. As you begin to settle in remember to join in the traditions of the Oiler Family! Challenge yourself in and outside of the classroom and ask for help when needed. I am excited to have you as an Oiler Family member and can't wait to see all of the great things you will accomplish here.

Go Oilers and always remember...PRIDE HONOR SUCCESS!

John Palombo  
Principal

# Pearland High School

## Profile of a Graduate

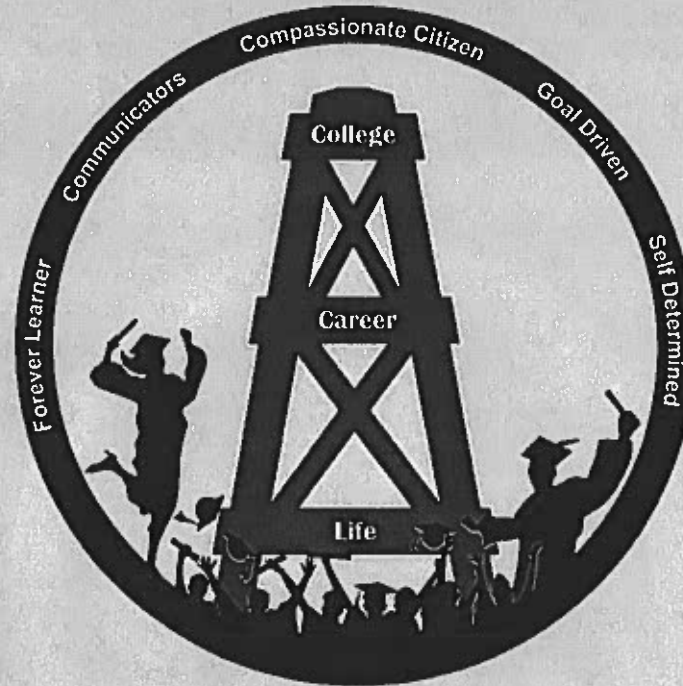

### **Forever Learner**

Understanding Across Curriculum  
Find Their Passion  
Be Active Readers

### **Communicators**

Verbal and Nonverbal  
Visual and Written  
Formal and Informal

### **Compassionate Citizen**

Social Emotional Tool Kits for Self Care  
Culturally Aware  
Empathetic  
Service Oriented

### **Goal Driven**

Build Relationships  
AP/PAP Participants  
Multi Disciplinary Learning  
Career Certifications

### **Self Determined**

Understanding the Importance of Education  
Self Accountability

## **PHS Fight Song**

**Oilers of maroon and white go on to victory.  
Everyone from PHS is singing praise to thee.  
All you Oilers loyal and true,  
If you fight you're sure to come through.  
Hail, hail, the gangs all here and we're cheering  
For Pearland High!**

## **PHS School Song**

**Hail to Pearland High  
We pledge our love to thee  
Always we're praising  
Everything you do.  
In defeat or victorious fame,  
Our hearts remain the same.  
Hail to Pearland High!  
Hail to Pearland High!**

**PEARLAND HIGH SCHOOL**  
**2021-2022**  
**QUICK REFERENCE**

Pearland High School 3775 South Main Pearland, Texas 77581 281.997.7445 <a href="http://www.pearlandisd.org/pearlandhs">http://www.pearlandisd.org/pearlandhs</a>	
---	---

IMPORTANT DATES	
Dates/Locations Subject to Change	
<b>Meet the Teacher Night</b>	
September 13, 2021 6:30 pm - 8:00 pm	

Homecoming Activities	
OllerFest: October 6, 2021; Game: October 8, 2021 (Kick-Off 7:00 pm); Dance: October 9, 2021	

Prom	Graduation
Galveston Convention Center April 23, 2022	NRG Stadium May 27, 2022

John Palombo, Principal	
Alpha	Administrator
A	Audie Johnson, Associate
B-Clat	Eric Maxwell
Clau-Garc	Christina Foos
Gard-Joh	Tasha Williams
Joi-Mel	Andrea Gobert
Mem-Rami	Lynn Walker
Ramj-Swal	Nicole Sebok
Swam-Z	Stephanie Jaracz
Counselors	
Alpha	Counselor
A	Lisa Cudd, Lead Counselor
B-Clat	Lori Lee
Clau-Garc	Harriett Stewart
Gard-Joh	Maria Diaz
Joi-Mel	Yahaira Campble
Mem-Rami	Tara Viser
Ramj-Swal	Kim McNamara
Swam-Z	Debbie Lenamond

Holidays	
September 6, 2021	Labor Day
November 22-26, 2021	Thanksgiving
December 20-31, 2021- January 5, 2022	Winter Break
January 17, 2022	Martin Luther King, Jr
February 21, 2022	President's Day
March 14 -18, 2022	Spring Break
4/15 - 18, 2022	Good Friday
May 30, 2022	Memorial Day

Staff In-Service /No School for Students	
August 10 -27, 2021	Staff Development/Workday
October 11, 2021	Staff Development/Workday
January 3 -5, 2022	Workday
May 27, 2022	Workday

Social Media
Webpage: <a href="https://www.pearlandisd.org/pearlandhs">https://www.pearlandisd.org/pearlandhs</a>
Twitter: @PearlandHighSch
Instagram: @pearlandhighsch
Facebook: @Pearlandhighsch

Report Cards	
October 20, 2021	1st Nine Weeks
January 5, 2022	2nd Nine Weeks
March 23, 2022	3rd Nine Weeks
June 3, 2022	4th Nine Weeks

# PEARLAND HIGH SCHOOL

2021-2020

## QUICK REFERENCE

### Clubs and Organizations

Club and Organizations will hold Virtual Meetings for the 2021-2022 School Year

Academic Decathlon  
 Army JROTC  
 Art Club  
 Athletics/Student Athletic Trainer/Sports Medicine  
 C.I.T.Y. Christians in the Youth  
 Class of 2022  
 Class of 2023  
 Class of 2024  
 Class of 2025  
 Criminal Justice Club  
 DECA/Marketing Co-Op  
 EXPLORERS  
 FCA: Fellowship of Christian Athletes  
 FFA: National FFA Organization  
 Fine Arts: Band/Color Guard, Cheer, Choir, Dance/Prancers, Theatre  
 French Club  
 Gay/Straight Alliance  
 HOSA: Health Occupation Students of America  
 International Thespian Honor Society  
 Interact Club  
 National Honor Society  
 Oiler Vision  
 Peer Buddies  
 Science National Honor Society  
 Skills USA  
 Spanish Club  
 Spanish National Honor Society  
 Student Council  
 SWAT (Students Who Advocate Technology)  
 UIL Academics: All subjects  
 UIL Forensics/Debate  
 UIL Math  
 UIL One Act Play/Theatre  
 UIL Science  
 Yearbook (Gusher)

### Library Hours 6:45 am - 2:45 pm

#### STAAR Retest

English 1 ELA	Grades 9-12	December 7, 2021
English 2 ELA	Grades 9-12	December 9, 2021
Algebra 1	Grades 9-12	Testing Window December 7-10, 2021
Biology	Grades 9-12	Testing Window December 7-10, 2021
US History	Grades 9-12	Testing Window December 7-10, 2021

#### STAAR

English 1 ELA	Grades 9-12	April 5, 2022
English 2 ELA	Grades 9-12	April 7, 2022
Algebra 1	Grades 9-12	Testing Window: May 3-6, 2022
Biology	Grades 9-12	Testing Window: May 3-6, 2022
US History	Grades 9-12	Testing Window: May 3-6, 2022

#### Advanced Placement Exams

Week 1	May 2 - 6, 2022
Week 2	May 9 - 13, 2022

#### Final Exam Exemptions

~See Exemption Policy for Qualifications~

Grade	Fall Semester	Spring Semester
12th	Up to 4	Up to 7
11th	Up to 2	Up to 3
10th	Up to 2	Up to 3
9th	Up to 0	Up to 2

#### Campus Security

For the safety of our students, all visitors must present a picture ID to the Receptionist in order to obtain a visitor's pass.  
 Anyone other than a parent must be listed as an emergency Contact in order to pick up a student.

School Resource Officers - Pearland Police Department



**PEARLAND POLICE DEPT**

Officer Don Jones and Officer Tommy Landis

#### Dress Code

Students are expected to be in PISD approved dress code everyday with their PHS Student ID's.

## Oiler Nation Expenses

Throughout a student's time at Pearland High School, students will have fees charged to their Skyward Account.

<b>Required Fees</b>	
Student ID/Replacement	\$5.00
Supplies for each class	Varies per Class
Class Course Fees/AP Exam Fees	Found in Course Selection Handbook added to Skyward in September for the Fall Semester and January in the Spring Semester
<b>Optional Fees</b>	
Class Shirt	\$15.00 Plus
Parking	\$30.00
Yearbook	\$75.00
School Yearbook Photo	Varies on the Package
Senior Yearbook Photo	Varies on the Package
Technology Insurance	\$40.00
Homecoming Dance	Price to Be Determined
Prom Tickets (12 <sup>th</sup> Grade Only)	Price to Be Determined



**2021-2022 STUDENT DRESS CODE (Pre-K – 12<sup>th</sup>)  
PEARLAND INDEPENDENT SCHOOL DISTRICT**

7/6/21

***Face mask, face shields, or face covering may be worn at school and on school buses. Parents should provide the face mask, face shield, or face covering for their child to wear.***

The Pearland ISD Dress Code is established to teach grooming and hygiene, prepare students for success, prevent disruption in the instructional setting, and maintain a safe environment for all students.

Pearland ISD sets the following general expectations for grooming and dress:

- Students should come to school bathed and wearing clean clothes.
- Students' hair should be clean, neat, and well groomed.
- Appropriate undergarments should be worn and not visible.
- Clothing should be appropriately sized and of appropriate length.
- Clothing and accessories may not be worn in any way that reflects gang affiliation or conceals contraband.
- Apparel and accessories, including face masks, face shields, or face coverings with inappropriate writing, drawings, or advertisements, to include but not limited to, alcohol, tobacco, drugs, violence, occult, death, suicide, gang activities, sexual innuendos, cultural divisiveness, and racial intolerance may not be worn.

**Slacks, Jeans, Capri Pants, Skirts, Shorts:**

- Shorts and skirts must be worn no shorter than mid-thigh.
- Pants, shorts, and skirts shall be appropriately sized, fit securely at the waist, and shall not expose skin above the mid-thigh.
- Shorts or skirts must be hemmed, not cutoffs.
- Spandex, leather, suede, vinyl, or sheer (see-through) fabrics are not allowed.
- Cargo pants are not allowed.
- Stretch slacks and leggings (except under a dress, a jumper, or a skirt) are not allowed.
- Distressed jeans are allowed but shall not expose skin above the mid-thigh.
- Any student that violates these rules when wearing shorts or skirts, may lose the privilege of wearing shorts or skirts for the remainder of the year.

**Shirts and Blouses:**

- Shirts and blouses may be any color including solids, stripes, prints, and plaids. No see-through fabrics allowed. Collars are not required.
- Spirit shirts must be campus/district specific and may include college or professional sports teams.
- Must have sleeves, be appropriately sized, and of appropriate length.
- Spandex, leather, suede, vinyl or sheer (see-through) fabrics are not allowed.

### **Dresses or Jumpers:**

- May be any color including solids, stripes, prints, and plaids.
- Must have sleeves, be appropriately sized, and must be worn no shorter than mid-thigh.
- Spandex, leather, suede, vinyl, or sheer (see-through) fabrics are not allowed.
- Solid or multi-colored leggings may only be worn under a dress, jumper, or skirt. Leggings may not be worn with just a long shirt.

### **Hair:**

- Hair must be neat, clean, and well groomed.
- Distracting colors are not allowed.
- Facial hair must be neat, clean, and well-groomed/trimmed, and worn in a style that is not distracting.
- Head coverings such as hats, caps, or bandanas are not allowed. (An exception will be made for religious headwear)

### **Jackets and Coats:**

- Sweatshirts, sweaters, windbreakers, sports coats and blazers may be worn inside and follow the same guidelines as shirts and blouses.
- Full length jackets or coats commonly referred to as "trench" coats or "dusters" are not allowed.

### **Shoes:**

- Students must wear shoes appropriate for school.
- House slippers, slides, or flip flops are not allowed.
- All shoes must include a back strap over the heel.
- Wheels, noise makers, or lights are not permitted.

### **Accessories/Miscellaneous:**

- No more than two (2) earrings may be worn in the earlobe only.
- Nose rings, lip rings, tongue piercing rings, or other body piercing accessories are not allowed.
- Spacers or gauging of the earlobe are not permitted.
- Tattoos must be covered.
- Sunglasses or sunshades are not to be worn in building.
- Heavy chains or accessories with spikes or studs are not allowed.
- Any accessory that could cause injury will be prohibited.

THE PRINCIPAL/ASSISTANT PRINCIPAL(S) ARE AUTHORIZED TO MAKE DETERMINATIONS REGARDING WHETHER ANY FASHION, FAD, HAIR, JEWELRY OR ARTICLE OF CLOTHING IS INAPPROPRIATE FOR SCHOOL WEAR OR DISRUPTIVE TO THE EDUCATIONAL PROCESS OR SAFETY OF THE CAMPUS.

# DID YOU KNOW?



## TRUANCY

State law dictates that children who are enrolled in Pre-Kindergarten/Kindergarten as well as those aged 6-19 must attend school. Any student absent without parent/guardian or school permission and documentation may be considered truant.

## 90% RULE

To receive credit or a final grade in a class, students must attend at least 90% of the days the class is offered.

## EXCUSED/UNEXCUSED ABSENCES

Absences in which a doctor's excuse or a signed and dated parent note describing a valid reason that is received within 3 days of the absence will be **EXCUSED**. Undocumented or unacceptably documented absences are considered **UNEXCUSED**.

## ATTENDANCE LETTERS

Students with unexcused absences for **THREE OR MORE** days or parts of days within a four-week period or **TEN OR MORE** days or parts of days in a six-month period will receive a standard, district-generated attendance letter.

## DOCTOR VISITS

Health care professional appointments must be face-to-face consultations and documented with a note from the doctor. Phone or video (telemedicine or teledoc) appointments may be excused with a valid parent note.

## COLLEGE VISITS

Juniors and Seniors may take up to two days for college campus visits per year. Upon return students must bring documentation from the institution or a signed parent note stating date and purpose of visit.

# MY CHILD WAS ABSENT TODAY... WHAT SHOULD I DO?

## For appointments with a HEALTH CARE PROFESSIONAL:

- **Bring a note** from the doctor's office stating the date and time
- If student **begins classes or returns to school** on the same day as the appointment and provides a valid note upon return no absence will be recorded

## OTHER ABSENCES require a parent note following these guidelines:

- **Write on paper** – emails will not be accepted
  - Include:
    - Student first and last name
    - Grade
    - Id number (if known)
    - Date
    - Reason for absence
  - **Sign and date by a parent/guardian** – notes signed by students under 18 will not be accepted
  - **Submit note within three school days** of the student's return or the absence will be considered UNEXCUSED and count toward truancy

For more information contact  
your campus Attendance Office



Tardies	Number of Tardies	Consequences
<b>Reset @ Semester</b>	Tardy 6	Last Warning
	Tardy 7	2 Hour Dhall
	Tardy 10	4 Hour Dhall
	Tardy 13	1 Day LTISS
	Tardy 16	2 Days LTISS
	Tardy 19	2 Days LTISS and Individual Behavior Plan Written
	Parking Loss	Students who reach excessive tardies to their 1st period class, may lose parking privileges
	Exemption Loss	9 total tardies in a semester will constitute a loss of ALL exemptions



# Pearland High School Bell Schedules



2021-2022

Regular Bell Schedule			
Period	Start	End	Length
1st	7:15	8:03	48 Min
2nd	8:09	8:57	48 Min
3rd	9:03	9:51	48 Min
4th	9:57	10:51	52 Min
5th	See Below		
A Lunch	10:57	11:27	30 Min
Class	11:27	12:17	50 Min
Oiler Time	12:17	12:47	30 Min
Oiler Time	10:57	11:27	30 Min
B Lunch	11:27	11:57	30 Min
Class	11:57	12:47	50 Min
Class	10:57	11:47	50 Min
Oiler Time	11:47	12:17	30 Min
C Lunch	12:17	12:47	30 Min
6th	12:53	1:41	48 Min
7th	1:47	2:35	48 Min

Home Room Bell Schedule			
Period	Start	End	Length
1st	7:15	8:00	45 Min
2nd	8:06	8:51	45 Min
3rd	8:57	9:42	45 Min
HR	9:48	10:08	20 Min
4th	10:14	10:59	45 Min
5th	See Below		
A Lunch	11:05	11:35	30 Min
Class	11:35	12:25	50 Min
Oiler Time	12:25	12:55	30 Min
Oiler Time	11:05	11:35	30 Min
B Lunch	11:35	12:05	30 Min
Class	12:05	12:55	50 Min
Class	11:05	11:55	50 Min
Oiler Time	11:55	12:25	30 Min
C Lunch	12:25	12:55	30 Min
6th	1:01	1:45	44 Min
7th	1:51	2:35	44 Min

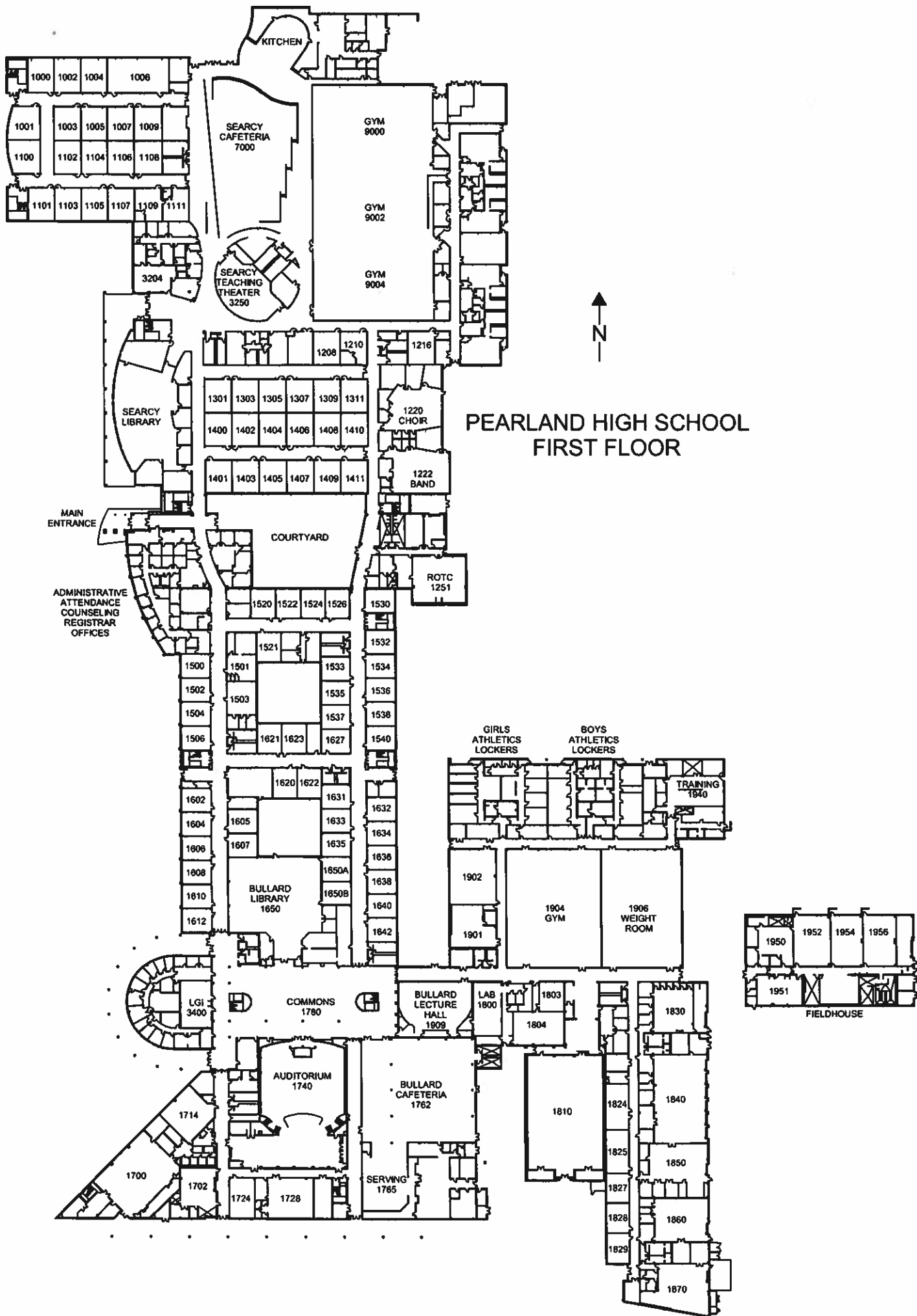

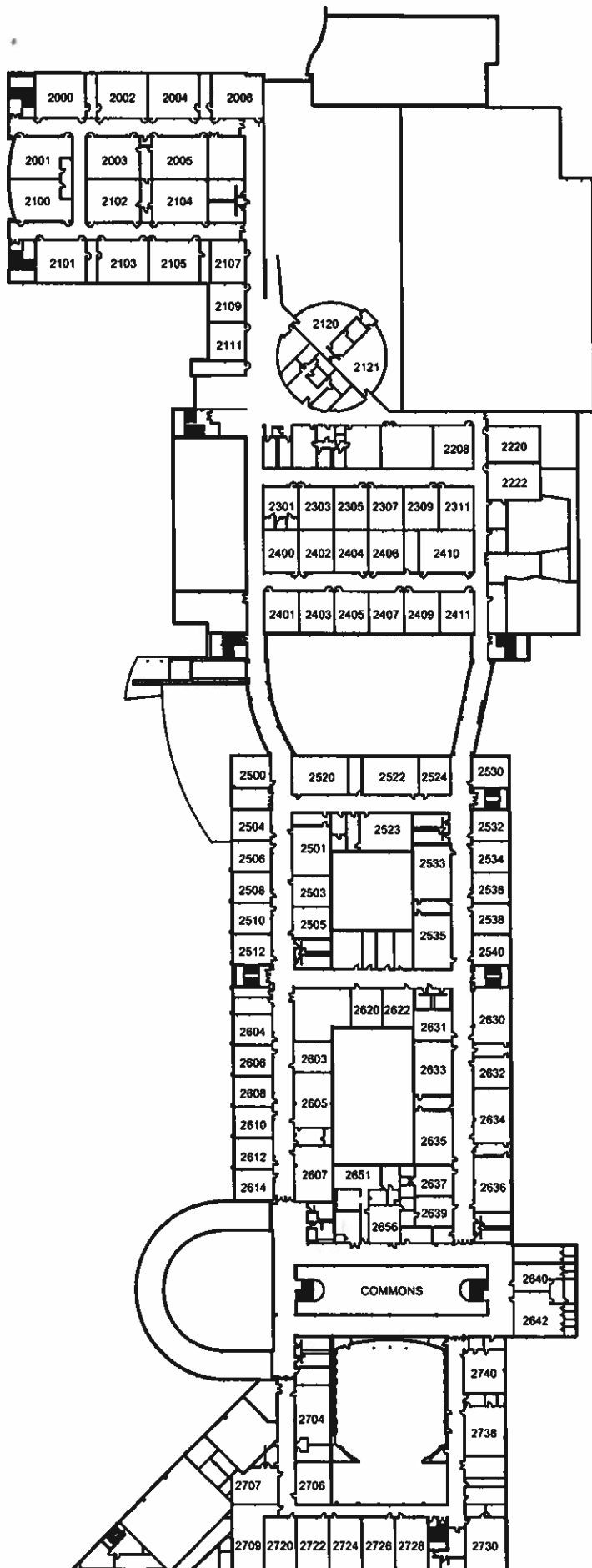

PEARLAND HIGH SCHOOL  
SECOND FLOOR